

COLLEGE MAP

PRINCIPAL'S PRESENTATION

Join our Principal, Mark Kent for his presentation at **5:10pm and 6:15pm in the Social Study Space** on the Ground Floor.

ENRICHMENT FAIR

In the **Main Atrium and LRC's**, you can find out about our wide range of **Student-Led Societies and Sports Enrichment**.

APPLY TODAY!

Ready to apply or have any questions? Visit our Admissions Team in the **Atrium**

Explore our brand new extension and our range of dedicated classrooms for T Levels which replicate real-life scenarios using high-tech digital simulation technology to enhance your skills, ready for your future career.

Join our Assistant Principal, Phil McPherson for his presentation at **5:40pm in the Social Study Space on the Ground Floor**

**T-LEVEL
ZONE**

Ready, steady, GO... find your course!

1 Find your course **2 Plan your route** **3 Enjoy!**

A LEVEL/ LEVEL 3

Course	Floor	Room
Arabic	First Floor	F40
Art & Design	Second Floor	S48
Biology	Science Centre	RO18
Business Studies	Ground Floor	MG01
Chemistry	Science Centre	RO19
Classical Civilisation	Second Floor	S36
Computer Science	First Floor	DF02/4
Dance	Second Floor	S10/11
Economics	Ground Floor	MG01
English Language	Second Floor	S30
English Literature	Second Floor	S31
Environmental Science	Second Floor	MS04
French	First Floor	F40
Further Mathematics	Ground Floor	G48
Geography	Second Floor	MS03
Geology	Second Floor	MS04
German	First Floor	F40
Graphic Design	Second Floor	S50
History	Second Floor	S43
Law	First Floor	F29
Mathematics	Ground Floor	G48
Media Studies	Second Floor	S45
Music	Second Floor	S61
Philosophy	Second Floor	S36
Photography	Second Floor	S2/S3
Psychology	First Floor	F1-F3
Physical Education	First Floor	F14
Physics	Science Centre	RO21
Politics	Second Floor	S43
Religious Studies	Second Floor	F1-F3
Sociology	First Floor	F40
Spanish	First Floor	G49
Statistics	Ground Floor	S50
Textiles	Second Floor	S52
3D Design – Product Design & Architecture	Second Floor	

BTEC/ VOCATIONAL/ LEVEL 3

Course	Floor	Room
Applied Human Biology	Science Centre	RO18
Applied Psychology	First Floor	F1-F3
Applied Science	Science Centre	RO18/19/21
Business	Ground Floor	MG01
Criminology	First Floor	F29
Dance	Second Floor	S10/11
Digital Games Design & Development	Second Floor	S46
Digital Games Production	Second Floor	S47
Digital Music Production	Second Floor	S61
Health & Social Care	First Floor	MF02
Law	First Floor	F29
Music Performance	Second Floor	S61
Musical Theatre	Second Floor	S10/11
Sports Coaching & Development	First Floor	F13
Sports & Exercise Science	First Floor	F14
Theatre	Second Floor	S10/11
TV & Film Production	Second Floor	S33

T LEVEL/ LEVEL 3

Course	Floor	Room
Digital Cybersecurity	First Floor	DF02/04
Digital Production, Design & Development	First Floor	DF02/04
Education & Childcare	Ground Floor	MG04
Finance	Ground Floor	MG01
Health	First Floor	MF01
Legal Services	First Floor	F29
Management & Administration	Ground Floor	MG01
Media, Broadcast & Production	Second Floor	S33
Science	Science Centre	RO18/19/21

Pathway Key

- Business, Finance & Law
- Education, Society, Sport & Health
- Science, Technology, Engineering & Maths
- Creative & Performing Arts
- Humanities, Languages & Literature

**Plan your route
on the floor
maps below!**



GROUND FLOOR

STAIRS LIFT TOILETS FIRE EXIT

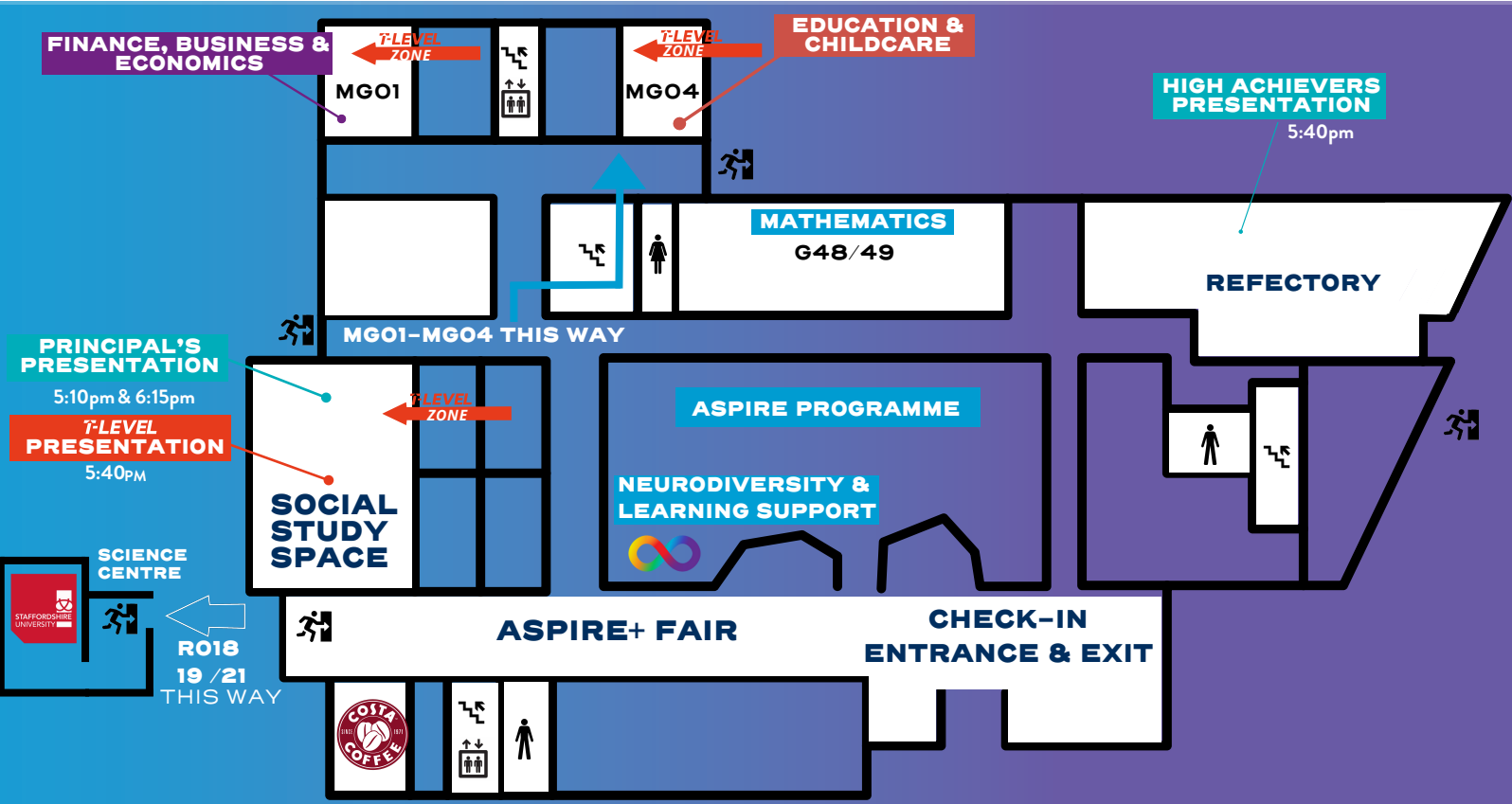

FIRST FLOOR

STAIRS LIFT TOILETS FIRE EXIT

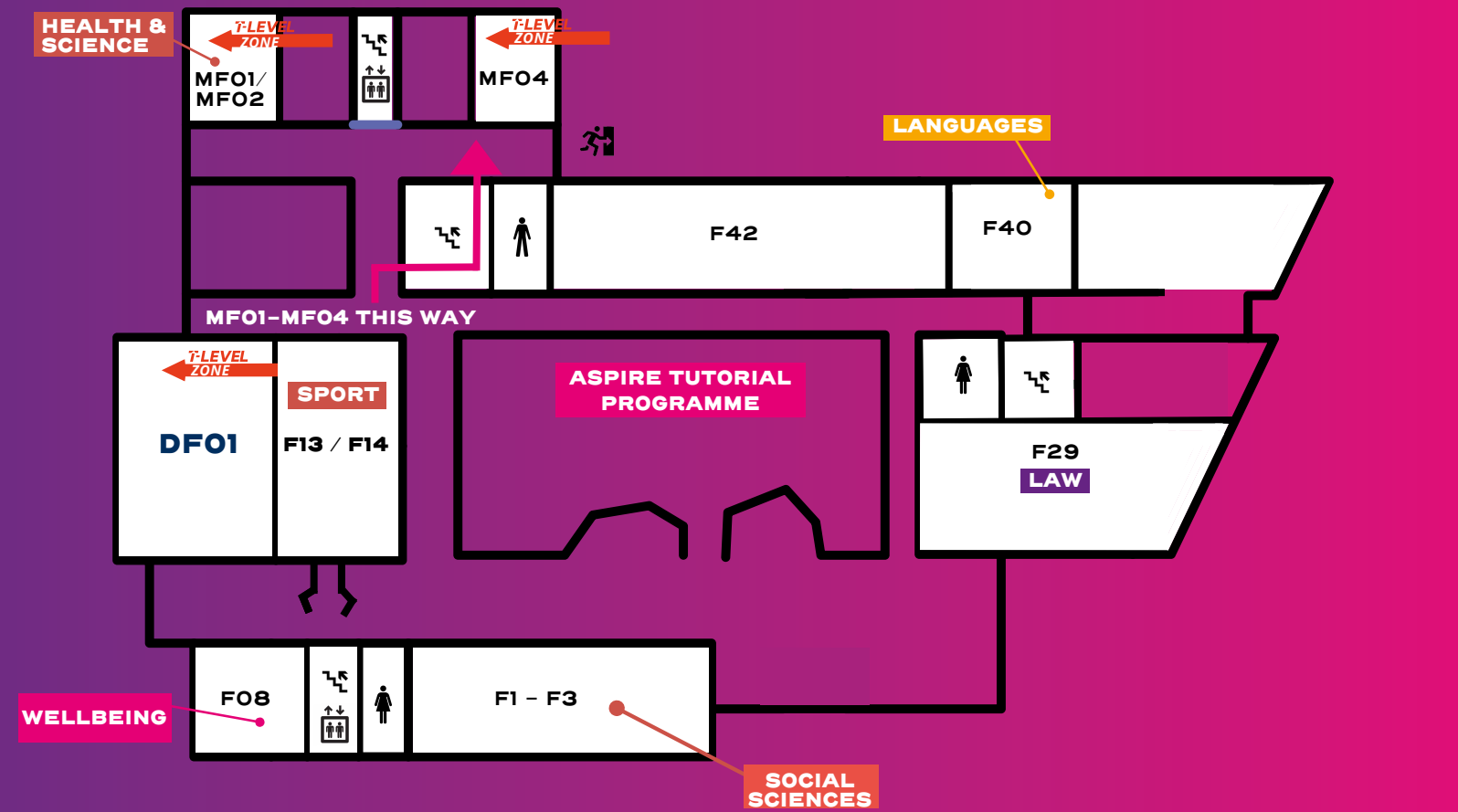

SECOND FLOOR

STAIRS LIFT TOILETS FIRE EXIT

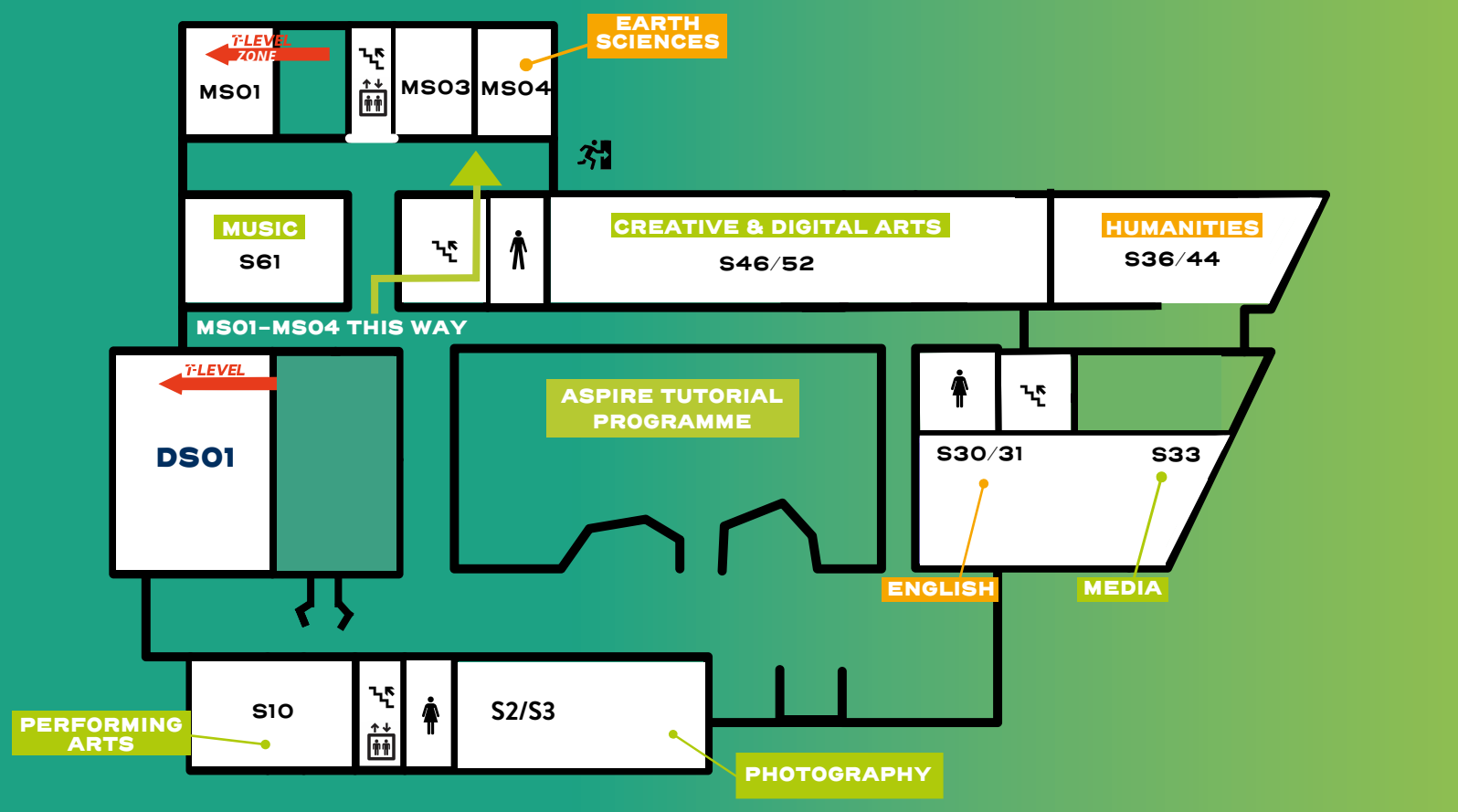

T: 01782 854221
E: admissions@stokesfc.ac.uk
W: www.stokesfc.ac.uk



facebook.com
 /SOT6thformcollege/SOT6FC



twitter.com
 /SOT6FC



youtube.com
 /SOT6FC



instagram.com
 /sot6fc